



KARTHICK REALTY

Elegant Living...

3 BHK VILLAS

A Chettinadu Elegance!!



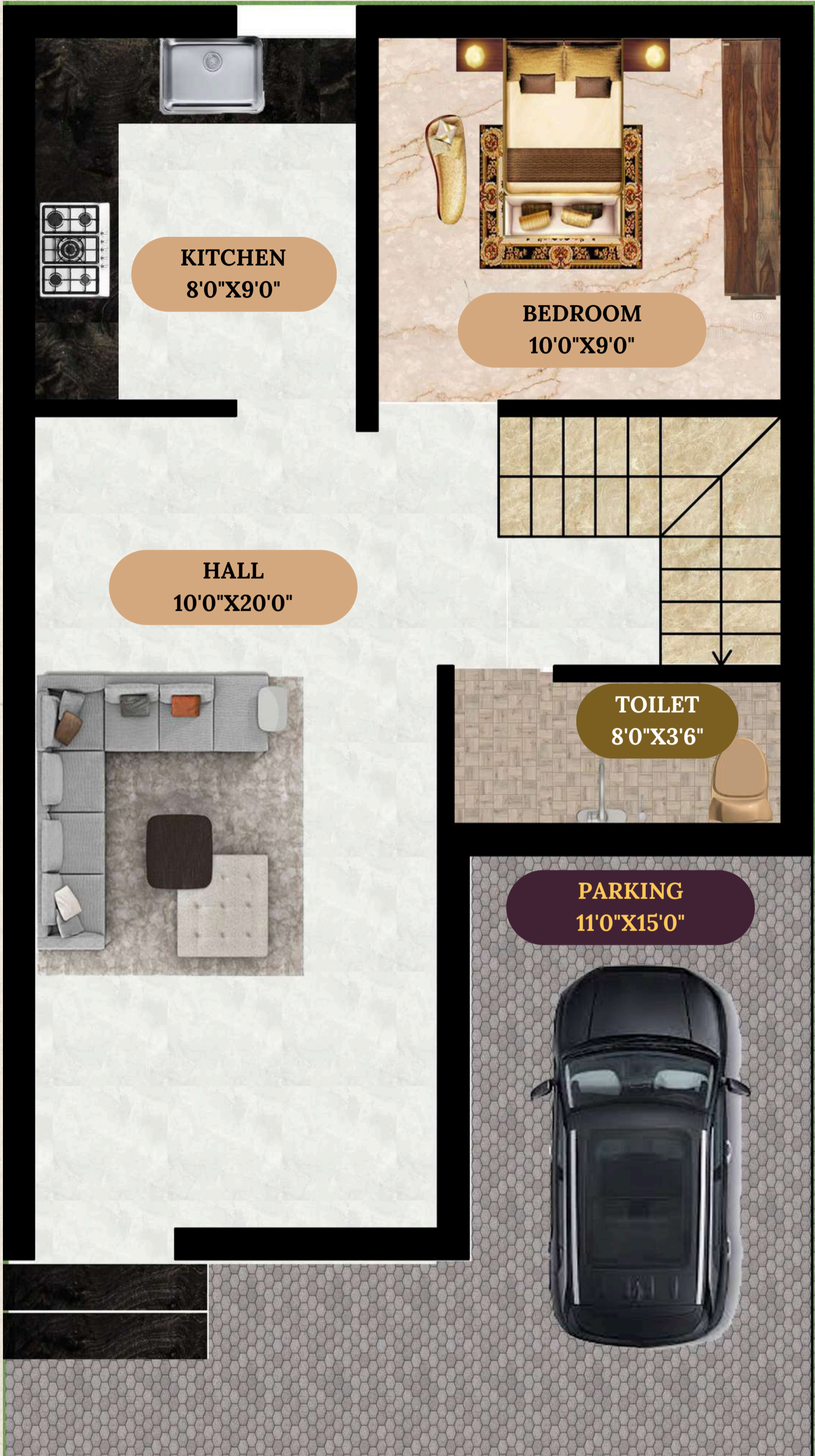

GROUND FLOOR PLAN





TOILET
7'0"X6'0"

TOILET
7'0"X4'0"

BEDROOM
12'6"X10'6"

HALL
13'0"X10'1.5"

BEDROOM
12'6"X10'0"

OPEN BALCONY
8'6"X10'0"

FIRST FLOOR PLAN



PROJECT DETAILS

TOTAL NUMBER OF HOMES

3



LAND AREA ≈ 960 SFT

BUILT UP ≈ 1300 SFT

- The Ground floor will have a parking space, a main hall, Kitchen, one bedroom and one bathroom.
- The First floor will have a hall, two bedrooms and one/two bathrooms.
- There is **no wall sharing** between homes.
- All homes will have sufficient setback space.
- The land space will be **separately** registered in the client's name and it will not be in UDS.

INTERIORS



- All interior work like shutters for cupboards and lofts will be done.
- Modular Kitchen will be done.
- TV unit will be provided in the ground floor hall.
- False Ceiling will be provided for ground floor hall.

ABOUT PAMMAL



- Pammal is located at just 2Km from the airport and 1Km from Pallavaram which is home to a booming IT and tech industry, with numerous global companies and startups driving innovation.
- Pammal has excellent educational institutions, old temples, tasty restaurants and much more.
- From traditional shopping centers like Chennai Silks, Pothys, Saravana Stores to modern malls like Aerohub mall etc., the location offers something for everyone.



SPECIFICATIONS

DESCRIPTION	SPECIFICATION
Type of structure	RCC Composite Structure
Height of floor (roof top)	10'0"
Walls	Red Brick Walls
Cement	ISI approved cement (Dalmia/ equivalent)
Steel	ISI approved steel - Fe 550D (Arun Plus/ equivalent)
Tiles	Flooring for Hall, Rooms and Kitchen - 2'x2' double charge vitrified tiles (Anuj/equivalent) Bathroom, Balcony, Staircase, Parking - 1'x1' ant-skid tiles (Anuj/equivalent)
Sanitary ware/fittings	Parryware/equivalent



SPECIFICATIONS

Kitchen counter top	Black granite top
Water lines	ISI approved PVC pipes for normal water and CPVC pipes for concealed water lines (Star/equivalent)
Door frames	Main door – Teakwood; Bedroom – Teakwood; Toilet doors – PVC
Doors	Main door – Teakwood; Bedroom – Film coated skinned doors/ Paneled doors; Toilet – PVC doors
Windows	UPVC sliding windows
Paint	Interior – Smooth finish with putty(Asian) and two coats of emulsion paint (Asian paints) Exterior – Dr. Fixit Raincoat NEO
Electrical	Wires – ISI approved copper cables in concealed PVC conduits (Orbit/Equivalent) Switches – GM/ Roma/Equivalent Modular Switches

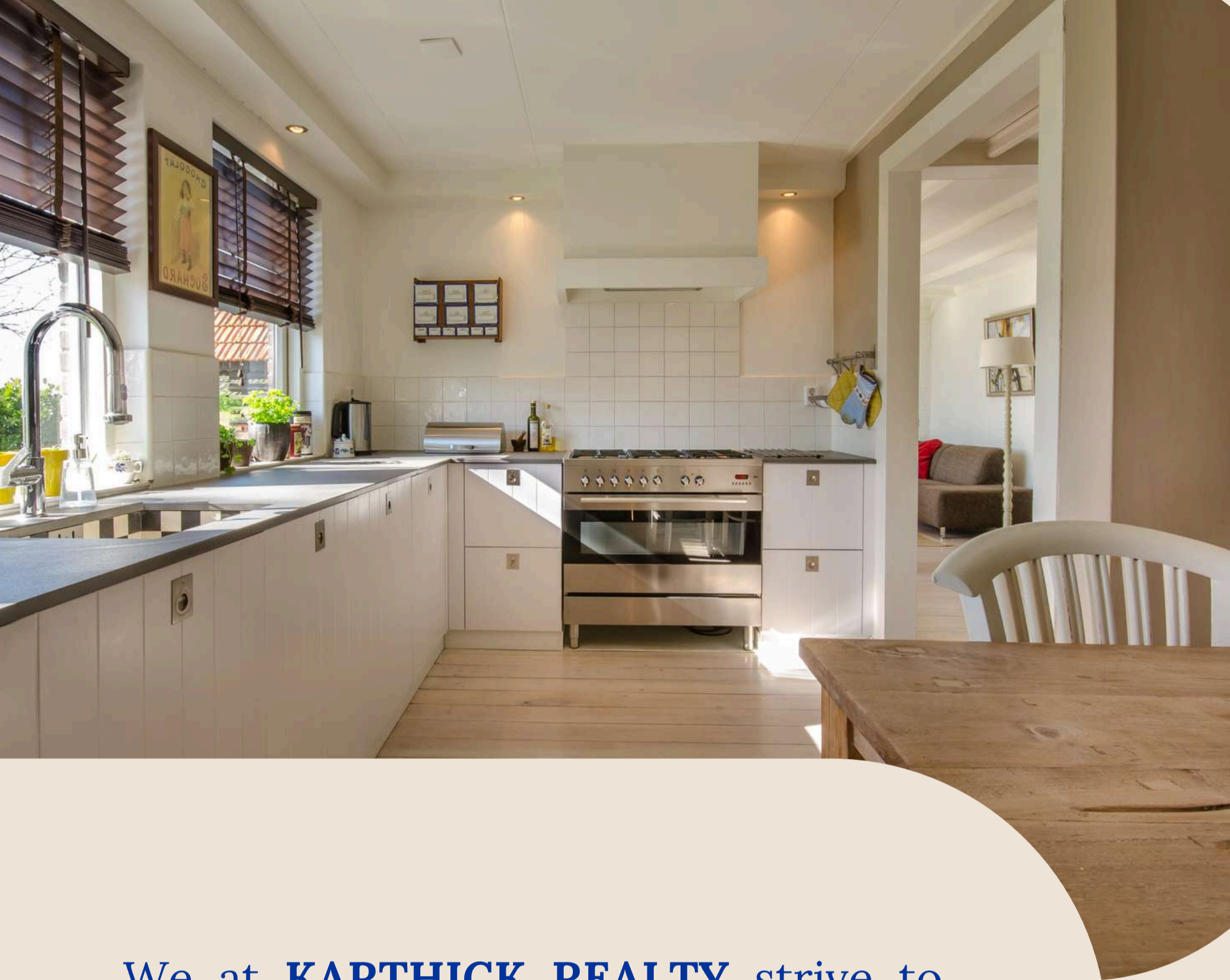

We at **KARTHICK REALTY** strive to give the best quality for your beautiful home at perfect locations.

GET IN TOUCH!



+91 94441 74326



sales@karthickrealty.com



www.karthickrealty.com